

ALL PROPERTY LINES ARE APPROXIMATE

Tweet Like 0

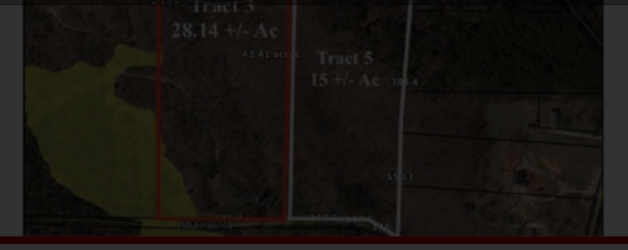

17+/- acre Tract 5  
Mullinax Rd. Zoned A-1

Approximately 17+/- ac. Tract 5.  
Wooded, Topography Level to  
Sloping, Zoned A-1 Bartow County.

\$ 127,500 \$7,500/acre



35.96+/- acre Tract 10  
Satcher Rd. Zoned A-1

SOLD! Approximately 35.96 ac.  
Tract 10, Wooded, Topography  
Level to Sloping, Zoned A-1 Bartow

\$ 212,164 \$5,900/acre



7.29+/- acre Tract 6  
Euharlee Rd. Zoned A-1

Approximately 7.29+/- acre Tract 6.  
Wooded, Topography: Level to  
Gentle (slight) Slope, Zoned, A-1 ...

\$ 57,591 \$7,900/acre