

SURVEYED FOR

**MITCHAM HOLDINGS, LLC**

IN LAND LOTS 94 & 95, 24TH DISTRICT,

3RD SECTION, GORDON COUNTY, GEORGIA

DATE OF PLAT 2-25-2011 SCALE 1" = 200'

DATE OF FIELD WORK 8-27-2010, 1-03-2011, 1-04-2011  
1-21-2011, 1-27-2011, 2-17-2011, 2-24-2011

8.651 ACRES FROM SOUTH BANK  
OF RIVER TO THE C.L. OF RIVER

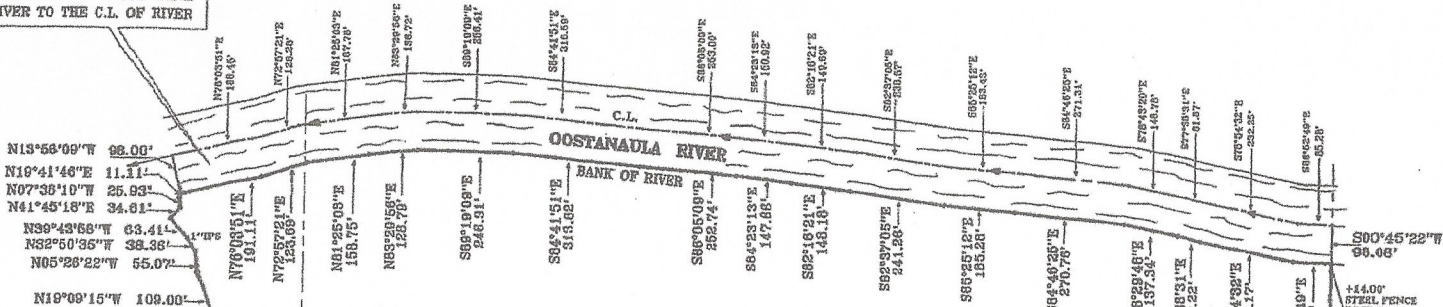

N15°58'09\"/>

N10°41'48\"/>

N07°39'10\"/>

N41°45'18\"/>

N39°43'68\"/>

N32°50'35\"/>

N05°28'22\"/>

N19°09'15\"/>

N15°32'53\"/>

N47°41'31\"/>

C.L. DITCH IS  
PROPERTY LINE

90.221 ACRES TO BANK OF RIVER

LL 94

LL 95

LL 107

LL 100

LL 95

LL 96

LL 106

LL 105

FIELD DATA:  
CLOSURE: 1" IN 24,300'  
EQUIPMENT: TOPCON GTS-302  
ANGULAR ERROR 0.4" PER ANGLE POINT  
BEARINGS: AER MAG. CAL FROM ANGLES  
TURNED.  
ADJUSTED USING LEAST SQUARES  
PLAT CLOSURE 1" IN 100,000'

\*FEMA FLOOD HAZARD MAP\* 15128C0480  
DATED SEPTEMBER 26, 2005, SHOWS THIS  
PROPERTY OUT OF FLOOD ZONE, EXCEPT AS  
SHOWN ALONG THE RIVER.

NOTE: THIS PLAT IS MADE FOR THE SOLE USE AND  
BENEFIT OF THE PERSON OR PERSONS NAMED HEREON.  
THIS FIRM ASSUMES NO LIABILITY TO PERSONS NOT  
NAMED HEREON AND ANY USE BY UNNAMED PARTIES  
WILL BE DONE AT THEIR OWN RISK.

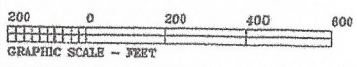

KNIGHT & KNIGHT LAND SURVEYORS, LLC  
116 CENTRE ROAD  
CARYTSVILLE, GEORGIA 30121  
TELEPHONE (770) 882-7975  
or (770) 882-5625

